

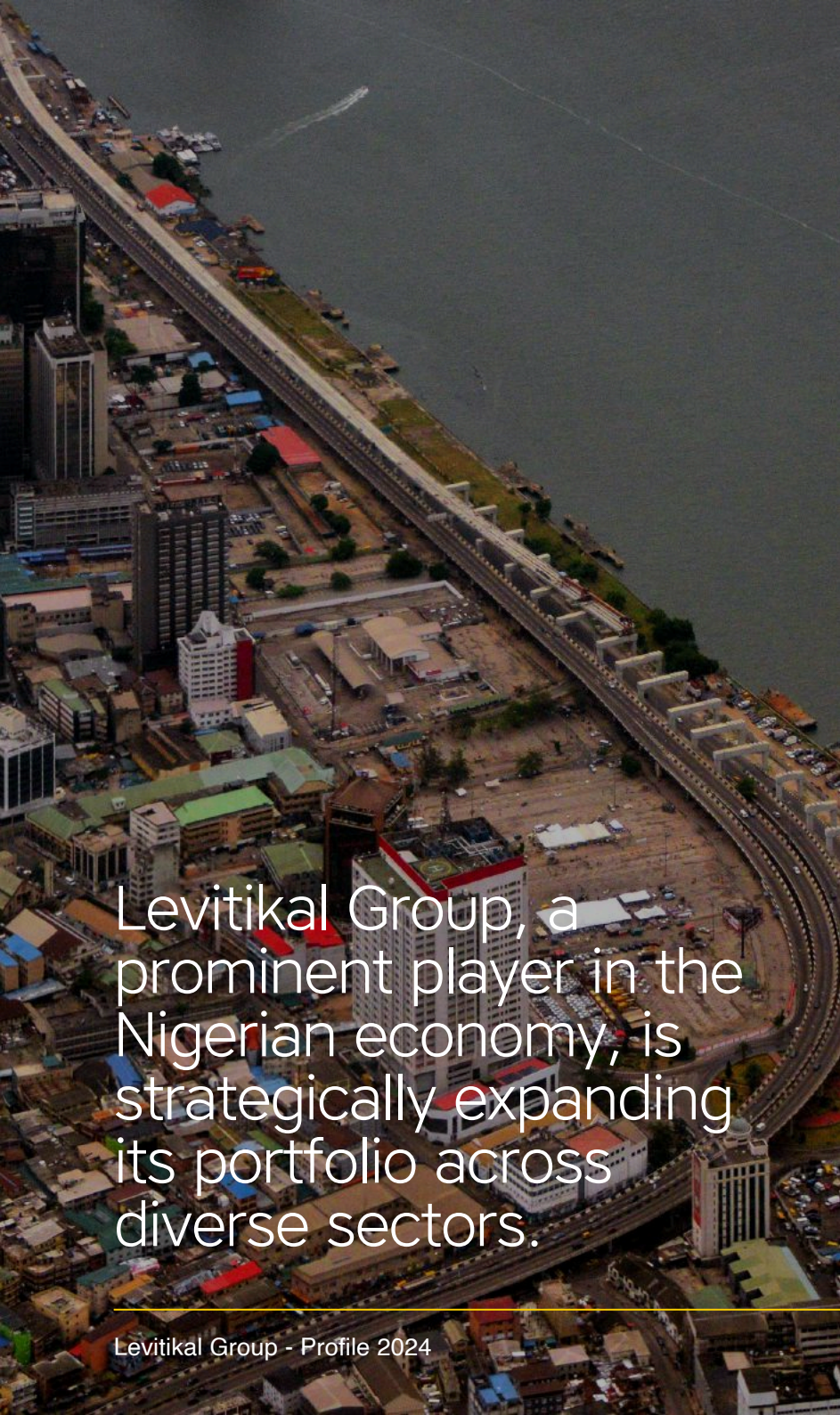

 Levitikal
GroupTM



The numbers don't lie. Levitikal group of companies is a proven leader in West African business ecosystem, boasting a history of 15yrs experience in the game



Levitikal Group, a prominent player in the Nigerian economy, is strategically expanding its portfolio across diverse sectors.



Incorporated primarily with the goal of leveraging strategic partnerships both locally and internationally in a bid to become a lead player in the industries we operate. At Levitikal Group, we strive for excellence in all we do and have drawn up ambitious plans to set up world-class projects. In summary, we are growth-oriented, uniquely positioned and result driven.



100% Satisfaction

We care about our clients. We have a burning passion and desire to meet their needs and exceed their expectations because we understand the intricacies of business across the globe, We do not disappoint,

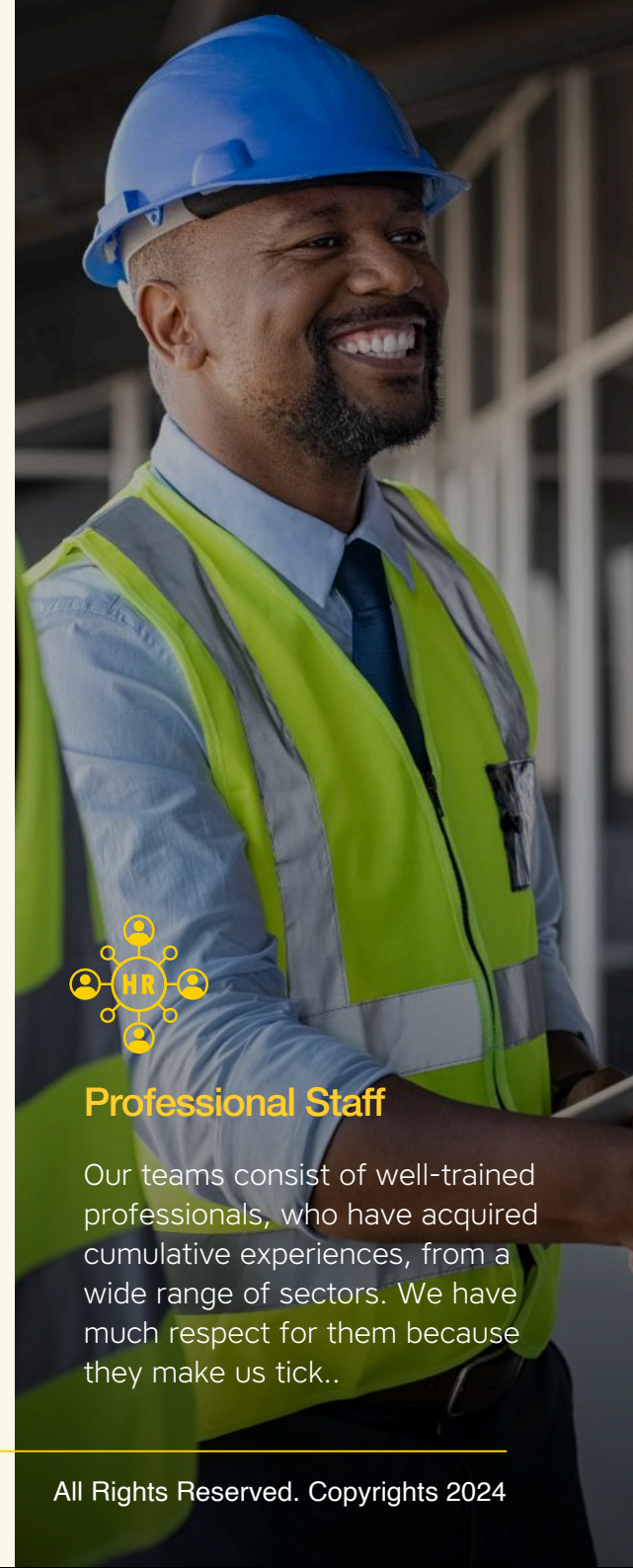

Professional Staff

Our teams consist of well-trained professionals, who have acquired cumulative experiences, from a wide range of sectors. We have much respect for them because they make us tick..

What drives us?

We have respect for our esteemed clientele and staff. We always live up to our promises as we always seek to go above and beyond' in service delivery. We pay attention to details.



Our Mission

To give a competitive edge to our clients over their contemporaries in their various businesses and industries while drawing the businesses closer to their objectives.



Our Vision

To be a recognized leader in providing the highest quality services across the sectors in which we operate.



Our Values

To deliver on our promise of high standard professional services and timely delivery to our clients.

Levitikal Group: Quick Facts



Realities &
Construction



Hotels &
Entertainment



Farm & Agro
Energy Limited



Ready Mix



Paint
Manufacturing

Multi-faceted Nigerian conglomerate

Operating across various key sectors of the economy. (Highlights diversification)

Visionary Leadership:

Driven to become a leading player in each industry we serve.

Sustainable Practices:

Committed to responsible development and eco-friendly solutions. (Addresses environmental focus)

Global Expertise, Local Knowledge:

Leveraging international experience with a deep understanding of the Nigerian market. (Highlights unique value proposition)



PROFILES



Levitikal

Realities &
Construction[®]



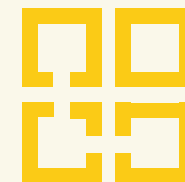

About Levitikal Realities & Construction

We are a forward-thinking construction company driven to become a leader in the Nigerian building industry. Our reputation rests on a foundation of excellence, encompassing innovative concepts, creative design, and flawless execution. We don't just build structures, we transform ideas into reality, exceeding expectations at every stage of the project.

Levitikal Realities & Construction redefines living and working spaces. We seamlessly integrate international expertise with a deep understanding of local architecture. Our focus? Creating sustainable, cost-effective solutions that leave a lasting positive impact.



With experienced, dedicated and highly motivated staff, state-of-the-art and efficient machinery, we are able to provide all of our clients with modern solutions.

We deliver exceptional results, exceeding your expectations and pushing the boundaries of what's possible. Our commitment to innovation and craftsmanship ensures every project is not just perfect, but leaves a lasting impact.



ONGOING PROJECTS

- Bourdillon Heights, Ikoyi, Lagos
- J Wesley, Victoria Island, Lagos
- 16 Glover, Ikoyi, Lagos
- Trinity Court, Victoria Island, Lagos
- Maryam Courts, Victoria Island, Lagos
- The Meridian Tower, Victoria Island, Lagos
- The Prime Meridian Aquatic Resort, Povita, Badagry, Lagos

COMPLETED PROJECTS

- Fabian Court, Ikoyi
- Fabian Terrace, Ikoyi
- Asher Court, Katampe, Abuja
- Vantage Courts, Victoria Island
- Sersigwe Farms, Keffi Road, Abuja
- 940 Minima Estate, Local Airport, Ikeja
- NAOWA Centre, Mambila Barack, Abuja
- 19A Lugard Avenue, Residential Mansion
- Eskor Mews, Dideolu Estate, Victoria Island
- Command Guest House, Yola, Adamawa State
- Beach Resorts Homes by Brains & Hammers, Lekki

CLIENTELE BASE

NOTE: Due to the Non-disclosure agreement signed by both parties, a whole number of Client data base will not be made available to the Public.

- Nigerian Army
- Arkland Properties
- Providus Bank
- Foundation System
- MISA Construction
- The Abacha Family
- R.C.C.C City of God
- Major Gen. BVT Kwaji (Rtd)
- Central Realities
- NALGE

ASSOCIATED BRANDS

- Kohler
- C.D.K Tiles
- Colorado Paints
- Baumatic Limited
- Daikin Airconditioner

The image shows three construction workers in silhouette against a bright, orange-hued sunset sky. They are wearing hard hats and high-visibility vests. The worker on the left is gesturing with his hand, while the other two are looking at a set of blueprints held by the middle worker. The worker on the right is holding a folder. In the background, the skeletal structure of a building under construction is visible, with vertical rebar columns and horizontal beams. The overall scene conveys a sense of active project management and collaboration in a construction environment.

PROJECTS

MERIDIAN TOWER

By Levitikal





MERIDIAN TOWER

By Levitikal

Resident Development Iconic Architecture
A 26 Storey NEO Modernism



1, 2,3,4 Bedroom Maisonette



3 Bedroom penthouse (1)



Bq



Swimmingpool



Automation



En suit Bathroom



Intercoms



Large Windows & Doors



Ample parking



Firealarm/smokedetector



Convertibleprivategym



24Hrs Security & CCTV



Roof Top Terrace



Modern Kitchen



For you to ascend to a realm where luxury knows no bounds, and your dreams become reality.

Our residences breathe innovation, seamlessly integrating first-of-its-kind technology that defies all odds of normalcy while sedulously enhancing every aspect of your daily routine. We understand that your investment deserves more than just indulgence-it deserves outstanding returns. Meridian Tower guarantees an exceptional 300 ROI, built upon a foundation of a visionary design, prime location, and unmatched amenities.

With its artistic design, Meridian Tower is undoubtedly the height of architectural genius, where you get to immerse in the peak of sophisticated living. Every detail has been meticulously curated to surpass expectations and enhance an extraordinary lifestyle. From exquisite craftsmanship to the finest materials sourced from around the globe, no compromise has been made in delivering the absolute best. Here, quality reigns supreme.

With its artistic design, Meridian Tower is undoubtedly the height of architectural genius, where you get to immerse in the peak of sophisticated living. Every detail has been meticulously curated to surpass expectations and enhance an extraordinary lifestyle. From exquisite craftsmanship to the finest materials sourced from around the globe, no compromise has been made in delivering the absolute best. Here, quality reigns supreme.





With its artistic design, Meridian Tower is undoubtedly the height of architectural genius, where you get to immerse in the peak of sophisticated living. Every detail has been meticulously curated to surpass expectations and enhance an extraordinary lifestyle. From exquisite craftsmanship to the finest materials sourced from around the globe, no compromise has been made in delivering the absolute best. Here, quality reigns supreme.



Comfort

Creating an elegant home that pays attention to your comfort as much as your grandeur



Exclusivity

Designing a stupendous condominium enhanced by world class cutting-edge technologies only for the discerning few.



Aesthetics

Intentionally creating a work of art that offers enchanting beauty of architecture and nature with impeccable views of the sea, skyline of Lagos, and unending inspiration.





KOHLER | Levitikal
Realities &
Construction®

Indulge in the opulence that reflects exclusivity

We ensure that every detail, no matter how minute, is given great attention. From the doors, interior designs, plumbing, and electrical systems, essential element of your residence, is executed with uncompromising precision, delivering nothing short of premium quality.

Our esteemed team of architects and diligent quality control experts bring their wealth of expertise to the forefront, harnessing the full potential of carefully selected materials sourced from renowned destinations like Italy, Spain, Germany, the UK, and France, to name just a few. This meticulous sourcing guarantees that every element of your home embodies the finest craftsmanship and durability.

At LEVITIKAL REALITIES & CON- STRUCTION LTD, we transcend convention- al standards and elevate quality to an iconic stature. It becomes a defining feature that sets us apart, empowering us to create spaces that exude timeless magnificence and leave a lasting impression.



For you to ascend to a realm where luxury knows no bounds, and your dreams become reality.

BH
BOURDILLON
HEIGHTS

BH

BOURDILLON
HEIGHTS

Resident Development Iconic Architecture
A 26 Storey NEO Modernism



1, 2, 3, 4 Bedroom Maisonette



3 Bedroom penthouse (1)



Bq



Swimmingpool



Automation



En suit Bathroom



Intercoms



Large Windows & Doors



Ample parking



Firealarm/smokedetector



Convertibleprivategym



24Hrs Security & CCTV



Roof Top Terrace



Modern Kitchen



For you to ascend to a realm where luxury knows no bounds, and your dreams become reality.

Welcome to Bourdillon Heights, where luxury living reaches its pinnacle, exclusively designed for the High and Mighty who demand the finest to match their opulent lifestyle. This ultra-luxurious high-rise in the heart of Ikoyi offers a thoughtfully crafted oasis where every detail caters to your desires and aspirations.

With its artistic design, Bourdillon Heights is undoubtedly the height of architectural genius, where you get to immerse in the peak of sophisticated living. Every detail has been meticulously curated to surpass expectations and enhance an extraordinary lifestyle. From exquisite craftsmanship to the finest materials sourced from around the globe, no compromise has been made in delivering the absolute best. Here, quality reigns supreme.



Our residences breathe innovation, seamlessly integrating first-of-its-kind technology that defies all odds of normalcy while sedulously enhancing every aspect of your daily routine. We understand that your investment deserves more than just indulgence-it deserves outstanding returns. Bourdillon Heights guarantees an exceptional 300 ROI, built upon a foundation of a visionary design, prime location, and unmatched amenities.

Vision:

Creating an ultra-modern home of timeless elegance that makes luxury living a lifestyle while setting the standard of architectural excellence in Nigeria.



With its artistic design, Meridian Tower is undoubtedly the height of architectural genius, where you get to immerse in the peak of sophisticated living. Every detail has been meticulously curated to surpass expectations and enhance an extraordinary lifestyle. From exquisite craftsmanship to the finest materials sourced from around the globe, no compromise has been made in delivering the absolute best. Here, quality reigns supreme.



Comfort

Creating an elegant home that pays attention to your comfort as much as your grandeur



Exclusivity

Designing a stupendous condominium enhanced by world class cutting-edge technologies only for the discerning few.



Aesthetics

Intentionally creating a work of art that offers enchanting beauty of architecture and nature with impeccable views of the sea, skyline of Lagos, and unending inspiration.





KOHLER

Levitikal
Realties &
Construction

Indulge in the opulence that reflects exclusivity

We ensure that every detail, no matter how minute, is given great attention. From the doors, interior designs, plumbing, and electrical systems, essential element of your residence, is executed with uncompromising precision, delivering nothing short of premium quality.

Our esteemed team of architects and diligent quality control experts bring their wealth of expertise to the forefront, harnessing the full potential of carefully selected materials sourced from renowned destinations like Italy, Spain, Germany, the UK, and France, to name just a few. This meticulous sourcing guarantees that every element of your home embodies the finest craftsmanship and durability.

At LEVITIKAL REALITIES & CON- STRUCTION LTD, we transcend convention- al standards and elevate quality to an iconic stature. It becomes a defining feature that sets us apart, empowering us to create spaces that exude timeless magnificence and leave a lasting impression.



Bourdillon Heights is intentionally situated at No 54b Bourdillon Ikoyi, to position you amidst the 1% of the 1% of Nigeria, the controllers of endless wealth. Here, your opportunity to grow your network is unlimited.

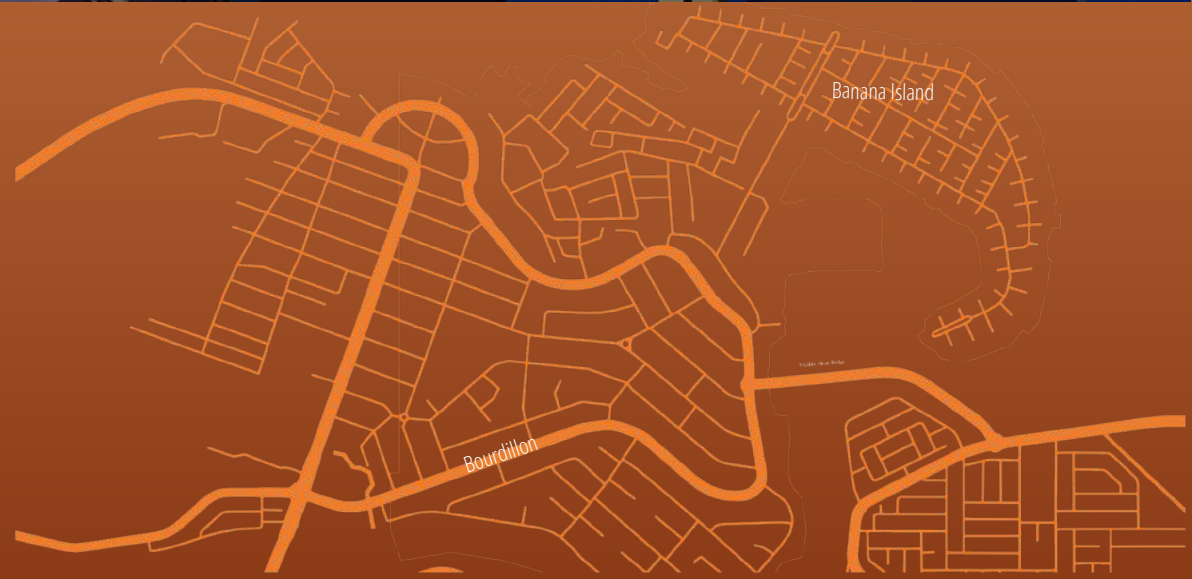

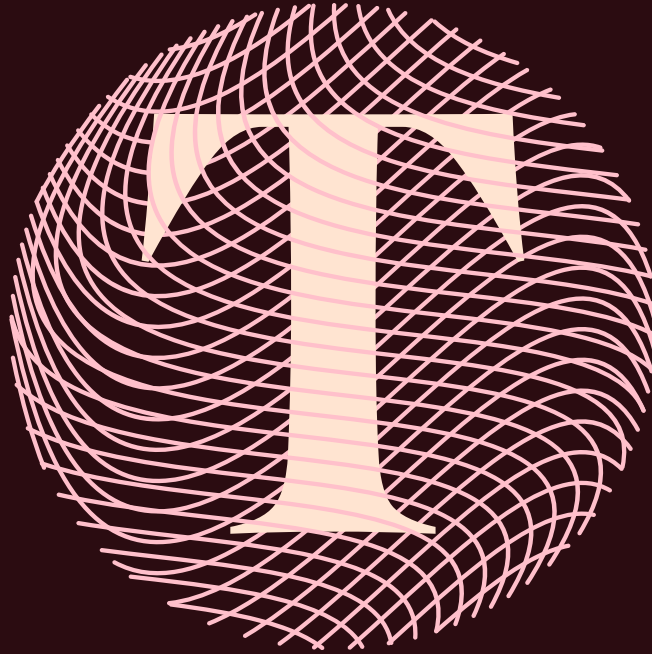

TRINITY COURT

By Levitikal Realities & Construction



Resident Development Iconic Architecture
A 26 Storey NEO Modernism



1, 2,3,4 Bedroom Maisonette



3 Bedroom penthouse (1)



Swimming pool



Roof Top Terrace



Automation



En suite Bathroom



Intercoms



Large Windows & Doors



Modern Kitchen



Ample parking



Fire alarm/smoke detector



Convertible private gym



24Hrs Security & CCTV

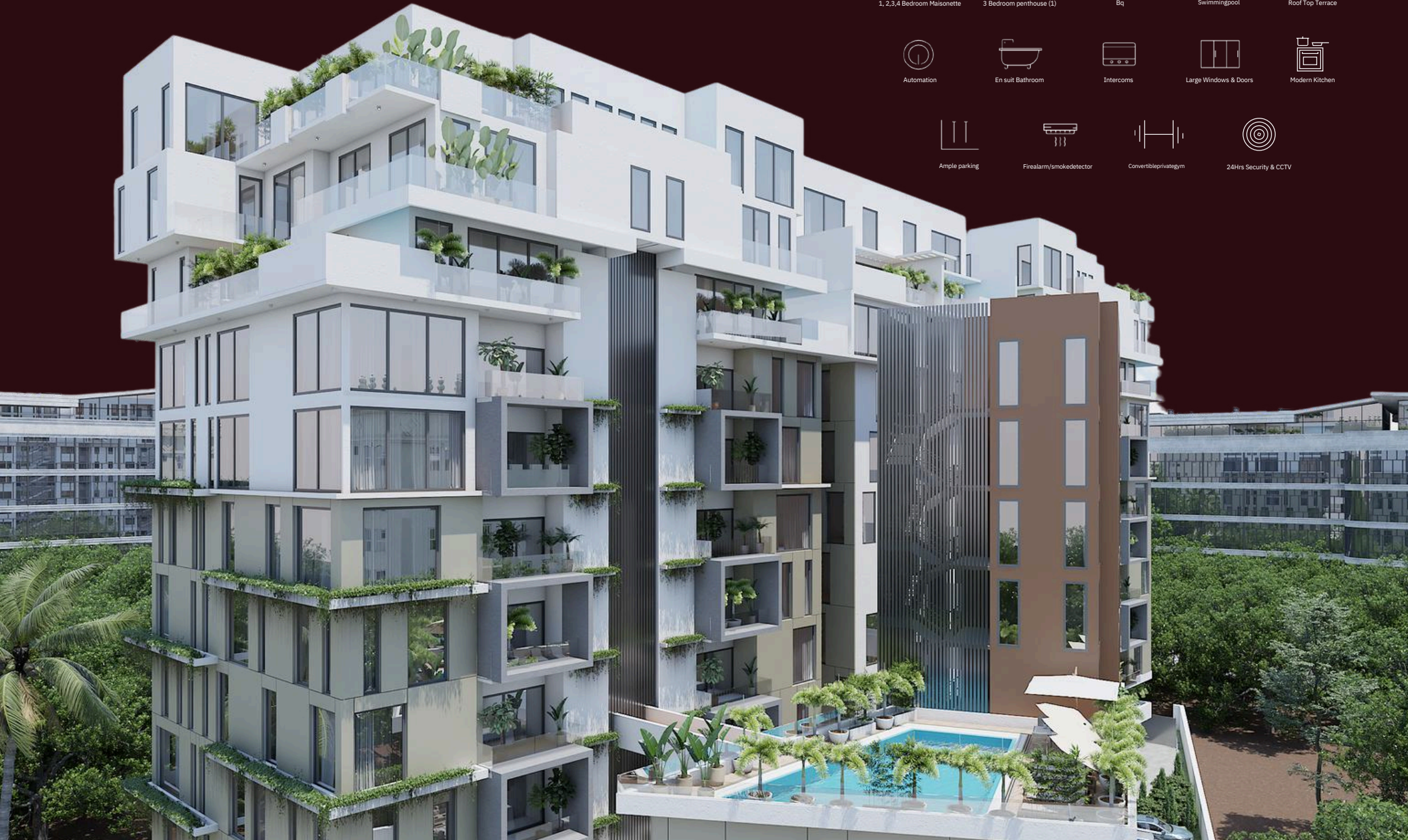

For you to ascend to a realm where luxury knows no bounds, and your dreams become reality.

Our residences breathe innovation, seamlessly integrating first-of-its-kind technology that defies all odds of normalcy while sedulously enhancing every aspect of your daily routine. We understand that your investment deserves more than just indulgence-it deserves outstanding returns. Meridian Tower guarantees an exceptional 300 ROI, built upon a foundation of a visionary design, prime location, and unmatched amenities.

With its artistic design, Meridian Tower is undoubtedly the height of architectural genius, where you get to immerse in the peak of sophisticated living. Every detail has been meticulously curated to surpass expectations and enhance an extraordinary lifestyle. From exquisite craftsmanship to the finest materials sourced from around the globe, no compromise has been made in delivering the absolute best. Here, quality reigns supreme.

With its artistic design, Meridian Tower is undoubtedly the height of architectural genius, where you get to immerse in the peak of sophisticated living. Every detail has been meticulously curated to surpass expectations and enhance an extraordinary lifestyle. From exquisite craftsmanship to the finest materials sourced from around the globe, no compromise has been made in delivering the absolute best. Here, quality reigns supreme.







J Wesley  Court





16 GLOVER





Resident Development Iconic Architecture
A 26 Storey NEO Modernism



1, 2, 3, 4 Bedroom Maisonette



3 Bedroom penthouse (1)



Bq



Swimmingpool



Roof Top Terrace



Automation



En suit Bathroom



Intercoms



Large Windows & Doors



Modern Kitchen



Ample parking



Firealarm/smokedetector



Convertibleprivatg.m



24Hrs Security & CCTV



Our residences breathe innovation, seamlessly integrating first-of-its-kind technology that defies all odds of normalcy while sedulously enhancing every aspect of your daily routine. We understand that your investment deserves more than just indulgence-it deserves outstanding returns. Meridian Tower guarantees an exceptional 300 ROI, built upon a foundation of a visionary design, prime location, and unmatched amenities.

With its artistic design, Meridian Tower is undoubtedly the height of architectural genius, where you get to immerse in the peak of sophisticated living. Every detail has been meticulously curated to surpass expectations and enhance an extraordinary lifestyle. From exquisite craftsmanship to the finest materials sourced from around the globe, no compromise has been made in delivering the absolute best. Here, quality reigns supreme.

With its artistic design, Meridian Tower is undoubtedly the height of architectural genius, where you get to immerse in the peak of sophisticated living. Every detail has been meticulously curated to surpass expectations and enhance an extraordinary lifestyle. From exquisite craftsmanship to the finest materials sourced from around the globe, no compromise has been made in delivering the absolute best. Here, quality reigns supreme.

With its artistic design, Meridian Tower is undoubtedly the height of architectural genius, where you get to immerse in the peak of sophisticated living. Every detail has been meticulously curated to surpass expectations and enhance an extraordinary lifestyle. From exquisite craftsmanship to the finest materials sourced from around the globe, no compromise has been made in delivering the absolute best. Here, quality reigns supreme.







PRIME
MERIDIAN
ACQUATIC & GOLF RESORT



Dear Guests,

Welcome to The Prime Meridian Aquatic And Golf Resort, your oasis in Badagry. Nestled in 17 hectares of lush parkland by the sea, we offer an experience of luxury and tranquility. With an infinity pool, a private beach, and stunning sunsets surrounded by Badagry's rich heritage, your stay here promises relaxation and wonder. Our commitment to personal service and warmth ensures your comfort and a desire to return. Thank you for choosing The Prime Meridian Aquatic And Golf Resort. We look forward to making your stay extraordinary.

Warm regards,
SAMUEL AJOSE CEO,
The Prime Meridian Aquatic
And Golf Resort, Badagry
Lagos



Prime Meridian: Your Partner in Reimagining Tourism

Strategic Location: A natural gateway for tourism on the Atlantic Coast.

Aligned Vision: Committed to Lagos' vision for Badagry and Nigeria's development.

World-Class Offerings: (Briefly mention unique tourist attractions)

DUALISED ACCESS ROAD WITH ADDITIONAL LANE TO EASE FLOW OF TRAFFIC INTO AND OUT OF THE FACILITY.

GOLF COURSE

GOLF COURSE

POWER STATION/ ELECTRICAL SERVICES

FIRE STATION, WATER TREATMENT AND MAINTENANCE OFFICE

87 CAPACITY HOTEL GUEST PARKING

HELIPAD

LAWN TENNIS COURT

HOTEL BUILDING (220 STANDARD ROOMS)
(44 EXECUTIVE SUITES)
(8 PRESIDENTIAL ROOM)

WATERPARK MAINTENANCE BUILDING

APARTMENT BUILDING (9 No 2 BEDROOM APARTMENT)
(18 No 1 BEDROOM APARTMENT)

WATERPARK RIDES

WAVEPOOL

SERVICE ENTRANCE / EXIT GATE

138 CAPACITY MULTIPURPOSE HALL PARKING

MULTIPURPOSE HALL

18 HOLE GOLF COURSE

CAFE, RESTAURANT, BAR AND LOUNGE BUILDING

58 CAPACITY PARKING

SECURITY WATCH TOWER

20 UNITS OF 4 BEDROOM + 1 MAIDS ROOM WATERFRONT VILLA WITH PRIVATE SWIMMING POOL & BOAT DOCK.

PRIVATE BOAT DOCK

BOAT CLUB BUILDING





58-CAPACITY
PARKING

HELIPAD

WORLD
CLASS
CASINO

220
STANDARD
ROOMS

WATER
PARKS

STANDARD
TENNIS
COURT

BOAT
CLUB

WATER
PARKS

WATER
FRONT
VILLAS

JETTY
SERVICES



PRIME
MERIDIAN
ACQUATIC & GOLF RESORT

Overview of the Resort.

Vision

At Levitikal Group, integrity and excellence are at the core of everything we do. We deliver on our promises, consistently exceeding expectations with high-quality professional services and timely project delivery. This unwavering commitment ensures our clients receive the reliable and efficient support they need to achieve their goals.

Mission

Our mission is to provide exceptional hospitality, recreational opportunities, and cultural enrichment, ensuring every guest departs with cherished memories and stronger family bonds.

Values

At Levitikal Group, integrity and excellence are at the core of everything we do. We deliver on our promises, consistently exceeding expectations with high-quality professional services and timely project delivery. This unwavering commitment ensures our clients receive the reliable and efficient support they need to achieve their goals.

Sustainability Initiatives

We recognize the importance of preserving the environment that surrounds us. As stewards of this breathtaking natural landscape, we are committed to sustainability initiatives that minimize our ecological footprint. From eco-friendly practices in our daily operations to a profound respect for the delicate ecosystem of Badagry, we strive to ensure that our resort remains in harmony with its surroundings. It is our duty to protect the pristine beauty that graces our shores, ensuring that future generations can enjoy the same tranquil paradise that awaits you at e Prime Meridian Aquatic And Golf Resort.





Room Types & Features

At the Prime Meridian Aquatic And Golf Resort, we offer an array of meticulously designed accommodations to cater to your every need. Our range of room types ensures that you find the perfect haven for your stay:



1 Bedroom Apartments (18 Units)

One-Bedroom Apartment:
Your Private Oasis

Indulge in comfort and space in our one-bedroom apartments, perfect for couples or solo travelers seeking a tranquil retreat. Designed with your relaxation in mind, these apartments offer a harmonious blend of style and functionality.

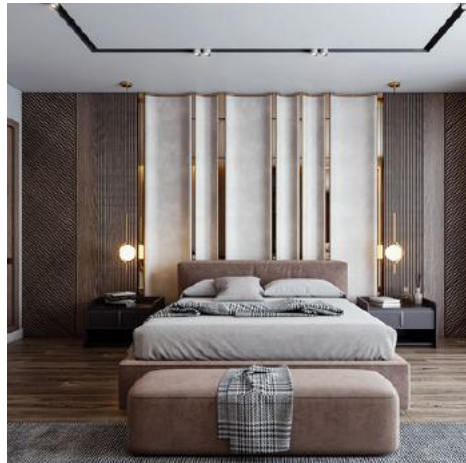

At the Prime Meridian Aquatic And Golf Resort, we offer an array of meticulously designed accommodations to cater to your every need. Our range of room types ensures that you find the perfect haven for your stay:



Room Types & Features

the project will create more and better accommodation options in Badagry. This will attract a wider range of tourists, leading to increased tourism revenue for the local community.

Construction needs local infrastructure upgrades (roads, utilities, etc.) These improvements benefit the whole community, making it more appealing to tourists and residents alike.

Our resort construction and operations will create local jobs, reducing unemployment and boosting the economy.



the project will create more and better accommodation options in Badagry. This will attract a wider range of tourists, leading to increased tourism revenue for the local community.

Construction needs local infrastructure upgrades (roads, utilities, etc.) These improvements benefit the whole community, making it more appealing to tourists and residents alike.

Our resort construction and operations will create local jobs, reducing unemployment and boosting the economy.









Levitikal

Ready-Mix Concrete

Levitikal Ready-Mixed Concrete offers a range of high-quality standard concrete mixes suitable for various applications, including foundations, slabs, columns, and more. Our standard product boasts the following features:



Levitikal Ready Mix Nigeria is more than just a concrete supplier; we are your trusted partner in building a stronger future.

Levitikal Ready Mix Nigeria is your trusted partner for superior concrete solutions, transforming construction visions into reality. We specialize in delivering tailored ready-mix concrete to meet the exact requirements of your project. Our unwavering commitment to quality, innovation, and customer satisfaction sets us apart.

With a robust network of commercial and dedicated project plants across Lagos, we cater to a diverse range of projects – from residential and commercial to large-scale infrastructure and civil engineering undertakings. Our expansive reach ensures we can meet the specific concrete requirements of any project, no matter the scale or complexity.

We're pioneering a new standard in the Nigerian market by combining our strong local presence in cement and concrete with strategic partnerships for aggregates and admixtures. This unique approach guarantees a reliable and high-quality supply chain, even in remote project locations. Our dedicated team and flexible plant operations enable rapid deployment and minimal disruption, ensuring your project stays on track.

Our unique selling points and benefits.

Unmatched Quality and Reliability

Our commitment to excellence extends beyond just delivering concrete. We employ rigorous quality control measures, backed by state-of-the-art testing facilities, to ensure every batch meets the highest industry standards. Our dedicated team of experts oversees the entire production process, from sourcing raw materials to final delivery, guaranteeing consistent quality and reliability.

Customization and Innovation

We understand that every project is unique. Our team of engineers and concrete specialists works closely with clients to develop customized concrete solutions tailored to specific project requirements. From high-strength concrete for demanding structures to specialized mixes for challenging environments, we have the expertise to deliver.

Sustainable Practices

Levitikal Ready Mix Nigeria is committed to environmental sustainability. We are continuously exploring ways to reduce our carbon footprint and minimize our impact on the environment. Our sustainable practices include responsible sourcing, waste reduction, and energy efficiency.

Exceptional Customer Service

Our customer-centric approach is at the heart of our business. We prioritize open communication, timely delivery, and technical support to ensure your project runs smoothly. Our dedicated customer service team is available to assist you with any inquiries or concerns.

Levitikal Ready-Mixed Concrete offers a range of high-quality standard concrete mixes suitable for various applications, including foundations, slabs, columns, and more. Our standard product boasts the following features:

DURABILITY

We use premium-quality materials and precise mix proportions to enhance the durability and longevity of our concrete.

HIGH STRENGTH

Our concrete is designed to provide excellent compressive strength, ensuring structural integrity.

WORKABILITY

Our concrete mixes have excellent workability, allowing for easy placement and finishing.

CONSISTENCY

With advanced batching technology, we maintain consistent quality throughout the production process.

SUPPORTING DOCUMENTS

Established in 2016, Levitikal Ready Mix Nigeria has rapidly grown into a leading provider of ready-mix concrete solutions in Nigeria. Our commitment to quality, innovation, and customer satisfaction has been the cornerstone of our success. With a comprehensive network of 2 plants strategically located in Nigeria, we are well-positioned to serve a wide range of construction projects, from residential to commercial and infrastructure.

Established in 2016, Levitikal Ready Mix Nigeria has rapidly grown into a leading provider of ready-mix concrete solutions in Nigeria. Our commitment to quality, innovation, and customer satisfaction has been the cornerstone of our success. With a comprehensive network of 2 plants strategically located in Nigeria, we are well-positioned to serve a wide range of construction projects, from residential to commercial and infrastructure.

With a comprehensive network of our plants strategically located across the region, we are well-positioned to serve a wide range of construction projects, from residential to commercial and infrastructure. We're pioneering a new standard in the Nigerian market by combining our strong local presence in cement and concrete with strategic partnerships for aggregates and admixtures.

This unique approach guarantees a reliable and high-quality supply chain, even in remote project locations. Our dedicated team and flexible plant operations enable rapid deployment and minimal disruption, ensuring your project stays on track.



ORGANIZATIONAL CHART

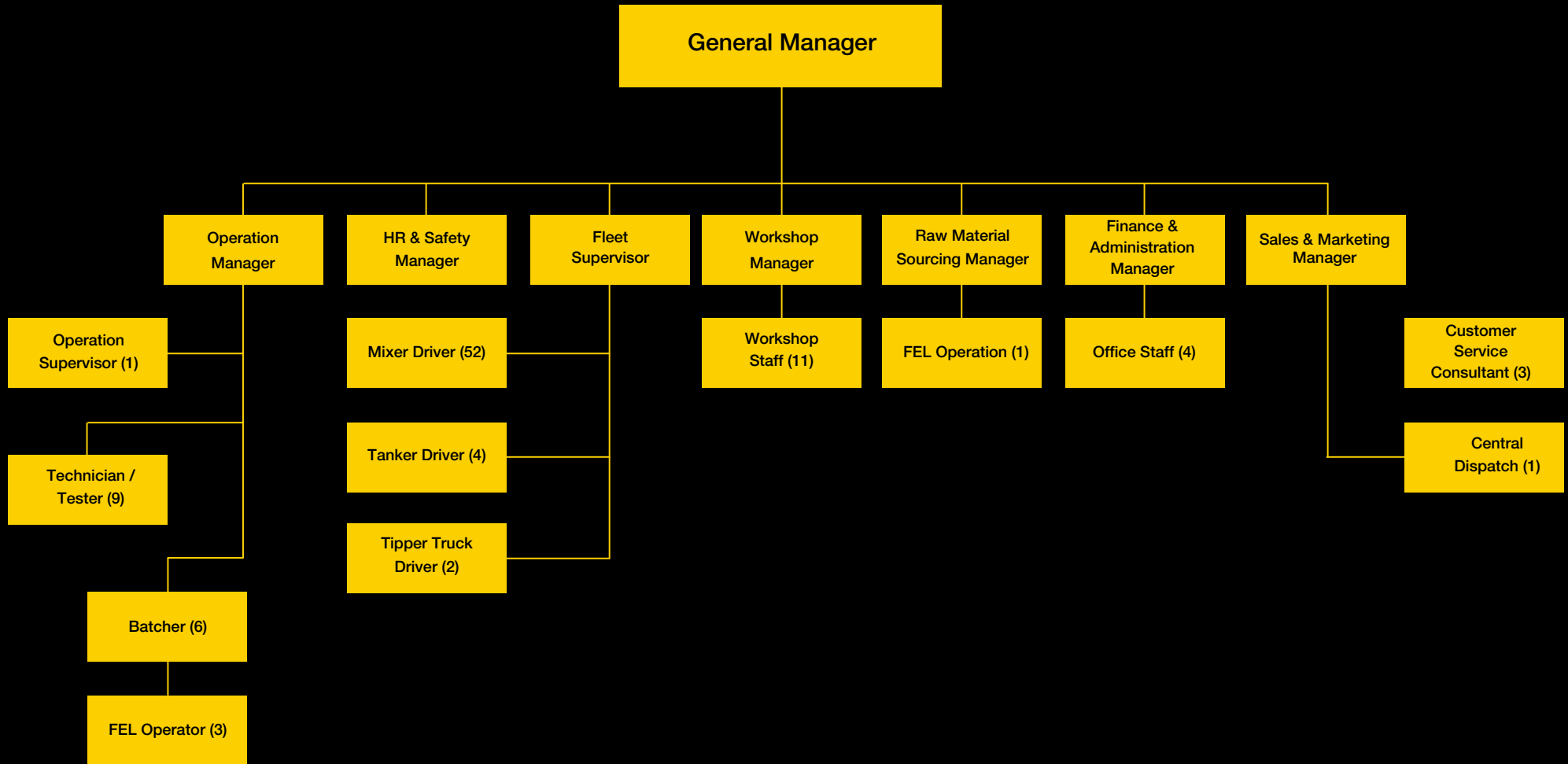

EQUIPMENTS

Levitikal Ready Mix Nigeria is equipped with state-of-the-art machinery and technology to ensure efficient and high-quality concrete production and delivery. Key pieces of equipment include:

- Batching Plants: These automated systems precisely measure and mix the various components of concrete, ensuring consistency and accuracy.
- Concrete Mixers: Large-capacity mixers thoroughly blend the ingredients to create a homogenous concrete mixture.
- Concrete Pumps: These powerful machines efficiently transport concrete to construction sites, even in challenging terrain or at high altitudes.
- Transport Trucks: A fleet of specialized trucks is used to deliver ready-mix concrete to customers promptly.
- Quality Control Equipment: Laboratories equipped with advanced testing machines are used to monitor and ensure the quality of concrete.





Levitikal

CONSTRUCTION EQUIPMENT LEASING

Levitikal Construction Equipment and Leasing is a division in Levitikal Readymix that offers construction equipment leasing and services to construction companies in Lagos and beyond. Leavitikal leasing came into existence in 2024, dominating the city of Lagos and its environs with new machines and equipment that deliver top-notch service to the construction sector.

We provide our customers with standard insured machines for seamless operations. Your project can proceed smoothly and as scheduled, enhancing overall productivity, reducing financial strain, and optimizing resource allocation.

When you choose Levitikal leasing for construction equipment rental, you expect;

- Compressive support and smooth project execution: From the inquiry to equipment delivery, our team is devoted to offering undivided support ensuring efficiency in our equipment delivery. We go as far as ensuring that our team or manpower and expertise are on the ground to ensure zero delays, annul any challenges and difficulties in equipment operation and services.
- Equipment guaranty and assurance: Standard Equipment Maintenance is knee and plays a vital role to ascertain smooth operation and services . Hence, all Levitikal Equipment undergoes proper inspection and maintenance routines before and after operation to ensure standard performance and reliability.
- Expert Benefit: We offer guidance from our experienced team who can give expert advice and recommendations according to the project needs.
- Promptness in Delivery: You can count on us to deliver all requested equipment on time, as service efficiency is paramount to us in the customer satisfaction scheme.

We render competitive and affordable services that proffers a cost-effective solution that helps you stay within budget while achieving quality construction project execution.

LEVITIKAL MOBILE - TRUCK MOUNTED CRANE:



Overall, Our 100-ton overhead crane is heavy-duty lifting equipment designed to handle large and heavy loads of up to 100 tons in industrial settings such as factories, warehouses, and construction sites. The crane is powered by electric motors and controlled through a remote control, or cabin. Its versatility, strength, and precision make it a critical tool in many heavy industries, contributing significantly to efficient and safe material handling operations.

Properties:

Net length of truck	Net width of truck	Net height of truck	Weight	Lifting height
100 tons	3.0m	3.9m	100 tons	63 main boom



Subsidiary of



LEVITIKAL EXCAVATOR



Our new high-quality excavator possesses a hack hammer that aids in demobilizing material, buildings, and others.

Properties:

Engine Power
241kw

Weight Mass
36050kg

Machine
325tbi

LEVITIKAL MOBILE- BOOM CONCRETE PUMP (56m)



Properties:

Levitikal mobile-boom concrete pump is compact in design, with a 56m pump mounted on 4 4-axle trucks. Weight is within the limit of the truckload.

The efficient pump unit consists of 2 Rexroth 180main pumps, generating 90 bar pressure on concrete with a smooth flow of 180m³/h. Agile Placing boom with 6 amps gives a wide work range

The controller is designed for heavy-duty use with a monitor, it monitors the pump intelligently on working data management, real-time diagnosis, alarm logging, and service interval notice. Rich in configurations and high-quality component

LEVITIKAL STATIONARY- LINE CONCRETE PUMP 1407HD

LEVITIKAL STATIONARY- LINE CONCRETE PUMP 1404HD



Properties:

Our Putzmeister 1407HD Concrete stationary pump is used for pumping distributing and placing concrete mortar and other high-density solids, and for temporarily storing, processing, and transporting this material.

BSA1407HD Properties

Output	Concrete Pressure	Delivery Cylinder	Hopper	Weight
72/48* m3/h	71/106* bar	200/1400mm	600L	4000kg

Properties:

Our Putzmeister1404HD Concrete stationary pump is used for pumping distributing and placing concrete mortar and other high-density solids, and for temporarily storing, processing, and transporting this material.

BSA1404HD Properties

Output	Concrete Pressure	Delivery Cylinder	Hopper	Weight
39/26* m3/h	70/105* bar	180/1000mm	600L	3300kg

LEVITIKAL CAT. PAYLOADER 950 F



Properties:

Operating weight	Height	Length with a bucket on the ground	Gross power	Net power
34,679lbs [15730kg]	12ft [4m]	25ft [8m]	180Hp	170Hp
Max speed [forward]	Max speed[reverse]			
24mph(39kph)	27mph(43kph)			

LEVITIKAL TRANSIT MIXER



Levitikal Construction equipment has over 20 Transit Mixer with 10m³ capacity

Properties:

Agitator Capacity	Max. Rotation	Filling Speed	Discharging Speed
10m³	12 – 16rpm	≥ 4m³ /min	≥ 3m³ /min
Water Tank	Water Supply Type	Range of Slump	Power Rating
450L	Air Pressure	50 – 210mm	247/1900 kwr/min

LEVITIKAL BULLDOZER



Properties: ---

LEVITIKAL BULLDOZER

Our Levitikal Bulldozers can assist greatly in the proper clearing of the site, spreading of materials in fine grade, contouring the land, and creating slopes and berms. They can move piles of trash. More interestingly, it can provide extra pushing power behind a single-engine scrapper.

It also possesses a front blade that can be easily swapped with a variety of blade shapes to address different jobs.

LEVITIKAL 500 KVA GENERATORS (PERKINS) & LEVITIKAL 150 KVA GENERATORS (PERKINS)



Properties: ---

LEVITIKAL 500 KVA GENERATORS (PERKINS)

The Perkins 500 kVA generator model with a prime power output of 500 kVA, 400kW and a standby output of 550kVA, 440kW at 0.8 power factor, 3 phase, 4 wire, 415/240 / 400/230 / 380/220 Volts, 50 Hz at 1500 RPM. The complete generating set is mounted in a heavy gauge steel, weatherproof and acoustic enclosure.

LEVITIKAL 150 KVA GENERATORS (PERKINS)

Our 150 kVA is powered by a Perkins diesel engine coupled to a Leroy Somer Brushless Alternator. It is supplied complete with lockable access doors and control panel and long range fuel tank. The diesel generators has been designed to meet Australian and European standards and are available for rental.

MANAGEMENT TEAM

MANAGEMENT TEAM

Sam Ajose

CHAIRMAN / CHIEF EXECUTIVE OFFICER

Samuel Mawuyon Ajose is a seasoned Chief Executive Officer with over 15 years of professional experience and more than a decade in executive leadership roles. He has a strong track record in managing and growing medium to large companies, particularly in the construction, real estate, and tourism industries. Samuel is known for his financial acumen, strategic planning, and ability to drive sales growth even in challenging market conditions.

As the CEO of Levitikal Groups of Company since 2016, Samuel has led significant organizational restructuring, enhancing productivity and fostering a culture of transparency and accountability.

Samuel holds a B.Sc. in Geography from the University of Ilorin and a professional certification in Set Design (Finishing).

He is committed to continuous business growth, effective stakeholder engagement, and the successful execution of strategic objectives. Samuel is based in Lagos, Nigeria.

Dr. Osigbodi Ajose

DIRECTOR OF STRATEGIC MANAGEMENT

Dr. Osigbodi Ajose is an accomplished strategic management professional with over 13 years of experience across banking, travel, public, and private sectors. She has expertise in strategic planning, financial management, human resources, marketing, and project management. As a leader, she is known for restructuring organizations, developing strategic initiatives, and fostering growth.

Dr. Ajose has held key roles, such as Team Lead at City Boy Movement and CEO of Travel Fix Limited, where she led successful campaigns, expanded businesses, and strengthened customer relations. She is a member of the Nigerian Institute of Management and the Institute of Chartered Economists.

Dr. Ajose holds a PhD and a Master's degree in Leadership & Strategic Studies from the Nigerian Defence Academy, and a Bachelor's degree in Political Science from Babcock University.

She is certified in negotiation skills, emotional intelligence, accounting, and marketing, and has basic knowledge of Hausa and Yoruba. With strong communication, leadership, and team management skills, she actively participates in political and community service initiatives, focusing on creating positive social and organizational impact.

MANAGEMENT TEAM

George Idornigie

CHIEF OPERATING OFFICER

George Idornigie is an Operations, Project Management and Commercial Operations Strategist who is adept at execution. He is an Alumnus of the Universities of Jos, Lagos as well as the Lagos Business School (LBS). George is a member of the leading professional bodies in Business Development, Project Management, Business Development, IMCI

Commercial Operations Management and Marketing with a Professional career spanning over thirty years which have included key leadership roles in Operations, Business Development, Investment Advisory as well as Strategy Direction within the International Development; Big 4 Management Consulting; Technology; Energy; Manufacturing; International Trade; ICT; Telecommunications and Real Estate Development sectors.

He has considerable experience working with the private sector, the Nigerian Government as well as NGOs in the conceptualisation and delivery of diverse projects. A Member of Ikoyi Club 1938, loves to network and play Golf at his leisure time

Oghomwen Ogbonmwan

GROUP HEAD, LEGAL & CONTRACTS

Oghomwen Ogbonmwan is an accomplished legal professional with extensive experience in corporate and commercial law, real estate and construction, property matters, finance, intellectual property, and technological transactions. She has worked with some of Nigeria's prestigious companies and law firms, where she honed her expertise in critical legal domains.

Oghomwen's skill spans a wide array of areas, encompassing compliance advisory, contract management, corporate governance, due diligence, stakeholder engagement and risk management. She is adept at managing complex legal transactions, including cross-border transactions and real estate deals, and excels in providing strategic legal counsel that drives innovation, enhances compliance, and contributes to revenue growth.

She holds LL.B. with honors from the University of Benin and a B.L. from the Nigerian Law School. Oghomwen is also an Associate of the Chartered Institute of Arbitrators, underscoring her commitment to excellence and her deep expertise in alternative dispute resolution.

MANAGEMENT TEAM

Joan Macauley

GROUP HEAD HR.

Joan Macauley is a seasoned Human Resource professional with a Master's degree in International Human Resource Management from Coventry University and a Bachelor's degree in Policy and Strategic Studies from Covenant University. With extensive experience across various HR roles, she has a proven track record in compensation management, employee engagement, and organizational development.

Joan has held key positions, including Compensation Specialist at USL & CAL WEC, where she managed compensation packages and led significant HR projects in the Well Construction business division across the US and Canada. She also served as a Human Resource Business Partner at Schlumberger Nigeria Limited, where she supported multiple business lines, managed employee relations, and oversaw HR processes during the challenging COVID-19 period.

Her skills include stakeholder management, effective communication, decision-making, and driving team collaboration. Joan is passionate about continuous learning, event planning, and traveling, and she has a strong commitment to enhancing organizational success through strategic HR initiatives. She is based in Abuja, Nigeria.

Dr. Agboola Ibukunoluwa

COMMERCIAL MANAGER LEVITIKAL READYMIX

Dr. Ibukunoluwa Agboola is a seasoned professional with over 20 years of experience in the private sector, specializing in project management, public policy analysis, and sustainable development. She has a PhD in Sustainable Development at the University of Abuja and holds a Master's in Financial Economics and a Bachelor's in Banking and Finance from the same institution. Dr. Agboola has demonstrated a strong track record of success in leadership roles, including her current position as Business Development and Commercial Manager at Levitikal Ready Mix Ltd.,

where she has implemented strategies to optimize production, enhance quality control, and drive business growth. Dr. Agboola is skilled in strategic planning, leadership, project management, and communication. Her significant achievements include expanding the customer base and revenue at Levitikal Ready Mix Ltd. She is proficient in data analytics and business analysis and has a strong commitment to community service.

MANAGEMENT TEAM

Adeshola Okesanya

HEAD OF SALES, LEVITIKAL REALTIES & CONSTRUCTION

Adeshola Okesanya is a driven Product Marketing Manager with over 8 years of experience, currently working at Levitikal Group in Lagos. She excels in strategic marketing, brand awareness, and product performance enhancement. At Levitikal Group, she leads a sales team of 8 specialists, achieving a 30% increase in revenue and overseeing investments worth over 2 billion Naira.

Adeshola's expertise in sales technology and market analysis helps identify new business opportunities, contributing significantly to the company's growth. With a strong background in sales management, she monitors and analyzes sales performance metrics and trends, driving exceptional revenue growth for the company.

Adeshola is skilled at motivating teams, leading initiatives, and implementing strategies that align with the organization's goals. She holds an HND in Mass Communication and Journalism from the Nigeria Institute of Journalism.

Uduak Wilson Udofia

PLANT MANAGER LEVITIKAL READYMIX

Uduak Wilson Udofia is an experienced Plant Manager at Levitikal, where he leads plant operations, ensuring efficient production and quality control. He manages personnel, optimizes processes, implements safety protocols, and maintains equipment to uphold high standards of quality and safety. With expertise in concrete mix design and material optimization, he ensures compliance with international standards and regulations.

Udofia holds an MBA, a Post Graduate Diploma in Business Management, and a Higher National Diploma in Applied Chemistry.

He is a certified lead auditor in Quality Management System (ISO 9001:2015) and has extensive experience in quality control for construction materials and batching plant operations. His leadership and technical skills have been pivotal in driving operational excellence and successfully delivering large-scale projects.

Randy Anoso

HEAD OF OPERATIONS READY MIX

Randy Catalla Anoso, born on June 23, 1972, in Tayabas, Quezon, Philippines, is an experienced Batching Plant Manager with a strong background in electrical engineering. He holds a Bachelor of Science in Electrical Engineering from the Technological Institute of the Philippines, where he studied from 1989 to 1994.

Randy has extensive experience in operations and management roles across various countries, including Nigeria, Qatar, Saudi Arabia, and the Philippines. He is currently employed as a Batch Plant Manager at Elalan Construction Company Nigeria Limited, where he has been since March 2019. His responsibilities include overseeing production processes, ensuring health and safety compliance, managing logistics, and maintaining high-quality standards in concrete production.

Randy has held key positions in companies such as Mobymix Concrete Industries Inc., LafargeHolcim Readymix Nigeria PLC, Ready Mix Qatar, and Al-Ghanim Ready Mix. His roles have ranged from Plant Supervisor to Area Manager, demonstrating his leadership and expertise in optimizing production costs, enhancing safety processes, and improving plant operations.

In addition to his technical skills, Randy is known for his strong problem-solving abilities, excellent customer service, and effective communication skills. He has also completed various trainings and seminars in leadership, health and safety, and risk assessment, further solidifying his expertise in the industry.

Kikelomo Olasunmbo Oretade

GENERAL MANAGER LEVITIKAL REALITIES & CONSTRUCTION

Kikelomo Olasunmbo Oretade is a seasoned Project Management Professional with extensive experience in the construction industry. She holds a B.Eng in Civil Engineering and has multiple certifications, including PRINCE2 and PMP.

Known for her collaborative and results-driven leadership style, Kikelomo has successfully managed diverse, high-profile projects such as residential high-rises, hospitals, and mixed-use developments across Nigeria, ensuring quality, safety, and client satisfaction. Kikelomo's expertise includes strategic planning, cost control, team building, and client retention.

As a Fellow of the Chartered Institute of Contract, Project and Facility Management, she is committed to continuous improvement, innovation, and delivering exceptional value to stakeholders in the construction sector.

Currently the General Manager at Levitikal Realities & Construction in Lagos, Kikelomo oversees strategic planning, project execution, and stakeholder relations. Her career spans roles at companies like Business Contracting Limited and De-Novelty Properties, where she led complex projects, driving growth and operational efficiency.

CERTIFICATIONS

SUPPORTING DOCUMENTS.

RC 1464226



CORPORATE AFFAIRS COMMISSION
FEDERAL REPUBLIC OF NIGERIA



Certificate of Incorporation

I hereby certify that

LEVITIKAL REALITIES AND CONSTRUCTION LIMITED

is this day incorporated under the COMPANIES AND ALLIED MATTERS ACT 1990 and that the Company is Limited By Shares.

Given under my hand at Abuja this 16th day of January, 2018.



AZUKA OBIAGELI AZINGE
Registrar - General

1089371

FEDERAL REPUBLIC OF NIGERIA
COMPANIES AND ALLIED MATTERS ACT, 1990
COMPANIES LIMITED BY SHARES
MEMORANDUM OF ASSOCIATION
OF

LEVITIKAL REALITIES AND CONSTRUCTION LIMITED

- The name of the Company is: **LEVITIKAL REALITIES AND CONSTRUCTION LIMITED**
- The Registered office Company will be situated in Nigeria
- The objects for which the Company is established are:
 - TO ACQUIRE LAND, BUILDINGS AND REAL ESTATE, TO ENGAGE IN THE SALE OF PROPERTY OF ANY DESCRIPTION (INCLUDING PATENT RIGHTS AND OTHER PROPRIETARY RIGHTS) AND TO HOLD, IMPROVE, ALTER, DESIGN, LET OR OTHERWISE DISPOSE OF SAME AND TO DEAL IN LANDED PROPERTIES
 - TO CARRY ON BUSINESS AS ESTATE AGENTS, MANAGERS, GENERAL CONTRACTORS, RENOVATORS, SUPPLIERS, PROPERTY DEVELOPERS AND ESTATE OWNERS, TO BUY, SELL, EXCHANGE, LEASE OR HIRE, DESIGN, DEVELOP, MANAGE, REFIT AND RENDR MARKETABLE PROPERTIES OF ALL KINDS.
 - TO CARRY ON THE BUSINESS OF CONSTRUCTION SERVICES OF EVERY DESCRIPTION AND TO ENGAGE (WITHOUT PREJUDICE TO THE GENERALITY OF THE FOREGOING) IN THE CONSTRUCTION OF COMPLEXES, PUBLIC UTILITIES OF ALL DESCRIPTION, ROADS, BRIDGES, WATERWAYS, WHARVES ETC
 - TO CONSTRUCT MANUFACTURING FACILITIES, POWER PLANTS, COMMUNICATION PROJECTS, SEWAGE WORKS AND DRAINAGE SYSTEMS, INCLUDING THE ERECTION, IMPROVEMENT, REPAIR, ALTERATION, MAINTENANCE AND DEMOLITION OF CONSTRUCTION WORKS.
 - TO CARRY ON BUSINESS AS MANUFACTURERS, SUPPLIERS, IMPORTERS, EXPORTERS, AND DEALERS IN ALL KINDS OF BUILDING MATERIALS AND BUILDERS REQUISITES; TO MANUFACTURE, SUPPLY AND DEAL IN BUILDING BLOCKS, BRICKS, GRANITE, GRAVELS, SAND AND

Stamp: CORPORATE AFFAIRS COMMISSION, Stamp Duty Cert. No: 2018-7184-9015-5747, 16 JAN 2018, TRUE COPY

Verify Electronic Stamp here: <http://www.cac.gov.ng/verify>

Stamp: CORPORATE AFFAIRS COMMISSION, VERIFICATION, 16 JAN 2018, 013

SUPPORTING DOCUMENTS.

6. TO TENDER FOR, NEGOTIATE, ENTER INTO, TAKE UP, TAKE OVER, LET OUT, GRANT AND OTHERWISE DEAL IN CONSTRUCTION CONTRACTS OF ALL DESCRIPTIONS, INCLUDING DESIGN CONSTRUCT CONTRACTS, CONSTRUCTION MANAGEMENT CONTRACTS AND JOINT VENTURES CONTRACTS.

7. TO BORROW OR RAISE MONEY IN SUCH MANNER AS THE COMPANY SHALL THINK FIT, AND IN PARTICULAR BY THE ISSUE OF DEBENTURES OR DEBENTURE STOCK (PERPETUAL OR OTHERWISE) AND TO SECURE THE REPAYMENT OF ANY MONEY BORROWED, RAISED OR OWING, BY MORTGAGE OR CHARGE.

8. To do all such other things as may be considered incidental or conducive to the attainment of the above objects or any of them.

4. The Company is a private company

5. The liability of the members is limited by share

6. The nominal share capital of the Company is 1,000,000.00 divided into 1000000 ordinary shares of 1.00 each.

We, the several persons whose names and addresses are subscribed hereunder, are desirous of being formed into a Company in pursuance of this Memorandum of Association, and we respectively agree to take the number of shares in the capital of the Company set opposite our respective names.

SN	NAME AND ADDRESS OF SUBSCRIBER	NO. OF SHARES TAKEN BY EACH SUBSCRIBER	SIGNATURES OF SUBSCRIBERS
1	Name: AJOSE MAWUYON SAMUEL Address: FLAT 3, PEACE APARTMENT BESIDE ADUVIE SCHOOL, JAHU (ABUJA, FCT ABUJA)	600000	
2	Name: AJOSE OSIGBODI Address: FLAT 3, PEACE APARTMENT BESIDE ADUVIE SCHOOL, JAHU (ABUJA, FCT ABUJA)	200000	
3	Name: AJOSE ZURIEL MAUTIN Address: FLAT 3, PEACE APARTMENT BESIDE ADUVIE SCHOOL, JAHU, ABUJA, FCT	100000	

Verify Electronic Stamp here: <http://comregulatory.gov.ng/verification> Stamp Copy Cert No: 2018-7394-56015-51717

FIRS
 IT ONLY TO PAY YOUR TAXES...

TAX CLEARANCE CERTIFICATE

TCC NO : 221583733316
 TAX OFFICE : MTO UTAKO
 DATE : 2021-03-05

Name of Company : LEVITKAL REALITIES AND CONSTRUCTION LIMITED
 RC No : 1464226
 Date of Incorporation : 2018-01-16
 TIN : 20759571-0001
 FIRS ID : 1901110003316
 Business Address : NO 46, KINGS-WAY ESTATE, FCT

Business Status : Yet To Commence Business

This is to certify that the above named company has rendered Income Tax, Value Added Tax, Information Technology Development Levy, Education Tax, as well as other tax returns and paid the assessed taxes in accordance with the relevant tax laws for all years including the past three assessment years as detailed hereunder.

	Assessment Year 2018	Assessment Year 2019	Assessment Year 2020
Turnover	NGN 21,139,191.00	NGN 21,139,191.00	NGN 21,139,191.00
Assessable Profit/Loss	NGN 435,904.00	NGN 1,469,821.00	NGN 1,469,821.00
Total Profit	NGN 311,847.00	NGN 489,940.00	NGN 489,940.00
Tax Payable	NGN 93,054.00	NGN 146,982.00	NGN 169,975.00
Tax Outstanding (If Any)	NGN 0.00	NGN 0.00	NGN 0.00

Source of Income : Construction of buildings
 Other Comments : SATISFACTORY
 This Certificate Expires on : 2021-12-31

Official Stamp Impression

IRO GARBA
 Tax Controller
 Name & Rank of Approving Officer

SUPPORTING DOCUMENTS.

6. TO TENDER FOR, NEGOTIATE, ENTER INTO, TAKE UP, TAKE OVER, LET OUT, GRANT AND OTHERWISE DEAL IN CONSTRUCTION CONTRACTS OF ALL DESCRIPTIONS, INCLUDING DESIGN CONSTRUCT CONTRACTS, CONSTRUCTION MANAGEMENT CONTRACTS AND JOINT VENTURES CONTRACTS.

7. TO BORROW OR RAISE MONEY IN SUCH MANNER AS THE COMPANY SHALL THINK FIT, AND IN PARTICULAR BY THE ISSUE OF DEBENTURES OR DEBENTURE STOCK (PERPETUAL OR OTHERWISE) AND TO SECURE THE REPAYMENT OF ANY MONEY BORROWED, RAISED OR OWING, BY MORTGAGE OR CHARGE

8. To do all such other things as may be considered incidental or conducive to the attainment of the above objects or any of them.

4. The Company is a private company

5. The liability of the members is limited by share

6. The nominal share capital of the Company is 1,000,000.00 divided into 1000000 ordinary shares of 1.00 each.

We, the several persons whose names and addresses are subscribed hereunder, are desirous of being formed into a Company in pursuance of this Memorandum of Association, and we respectively agree to take the number of shares in the capital of the Company set opposite our respective names.

SN	NAME AND ADDRESS OF SUBSCRIBER	NO. OF SHARES TAKEN BY EACH SUBSCRIBER	SIGNATURES OF SUBSCRIBERS
1	Name: AJOSE MAWUYON SAMUEL Address: FLAT 3, PEACE APARTMENT BESIDE ADUVIE SCHOOL, JAHU (ABUJA, FCT ABUJA)	600000	
2	Name: AJOSE OSIGBODI Address: FLAT 3, PEACE APARTMENT BESIDE ADUVIE SCHOOL, JAHU (ABUJA, FCT ABUJA)	200000	
3	Name: AJOSE ZURIEL MAUTIN Address: FLAT 3, PEACE APARTMENT BESIDE ADUVIE SCHOOL, JAHU, ABUJA, FCT	100000	

Verify Electronic Stamp here: <http://comregulatory.gov.ng/verification> Stamp Copy Cert No: 2018-9384-56015-51717

TAX CLEARANCE CERTIFICATE

TCC NO : 221583733316
TAX OFFICE : MTO UTAKO
DATE : 2021-03-05

Name of Company : LEVITKAL REALITIES AND CONSTRUCTION LIMITED
RC No : 1464226
Date of Incorporation : 2018-01-16
TIN : 20759571-0001
FIRS ID : 1901110003316
Business Address : NO 46, KINGS-WAY ESTATE, F01

Business Status : Yet To Commence Business

This is to certify that the above named company has rendered Income Tax, Value Added Tax, Information Technology Development Levy, Education Tax, as well as other tax returns and paid the assessed taxes in accordance with the relevant tax laws for all years including the past three assessment years as detailed hereunder.

	Assessment Year 2018	Assessment Year 2019	Assessment Year 2020
Turnover	NGN 21,139,191.00	NGN 21,139,191.00	NGN 21,139,191.00
Assessable Profit/Loss	NGN 435,904.00	NGN 1,469,821.00	NGN 1,469,821.00
Total Profit	NGN 311,847.00	NGN 489,940.00	NGN 489,940.00
Tax Payable	NGN 93,054.00	NGN 146,982.00	NGN 169,975.00
Tax Outstanding (If Any)	NGN 0.00	NGN 0.00	NGN 0.00

Source of Income : Construction of buildings
Other Comments : SATISFACTORY
This Certificate Expires on : 2021-12-31

Official Stamp Impression

ERO GARBA
Tax Controller

Name & Rank of Approving Officer

SUPPORTING DOCUMENTS.

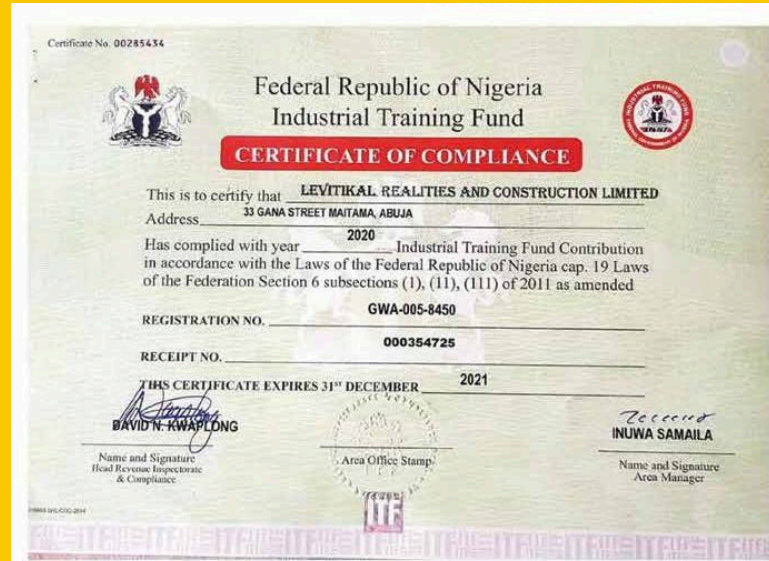



www.levitikalgroup.com

